

# PHANTOM 3

STANDARD

## Quick Start Guide

V1.0

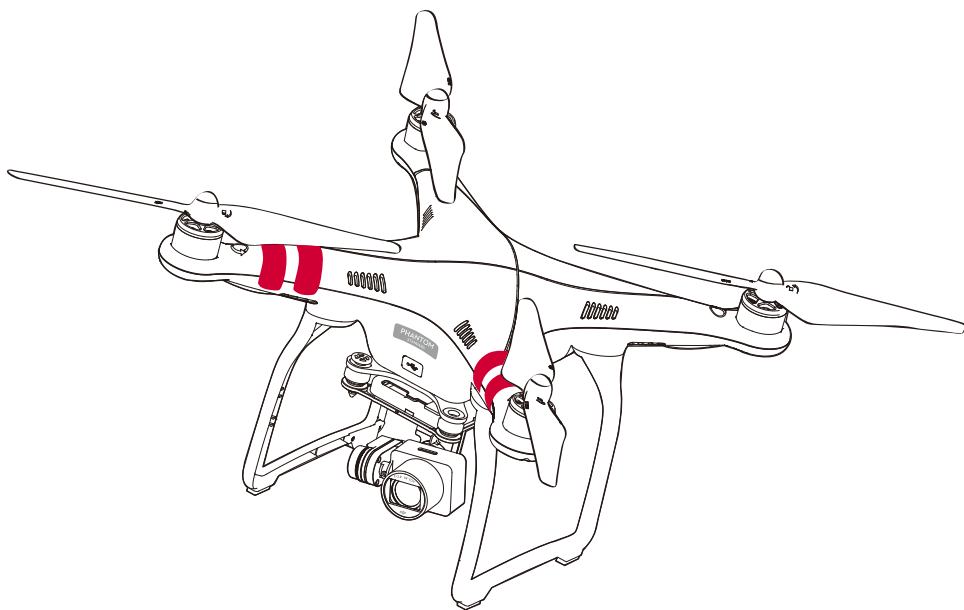

# Phantom 3 Standard

Let's get to know your Phantom!

The Phantom 3 Standard captures up to 2.7K Ultra HD video at 30fps and 12MP photos.

The diagram below is an overview of features:

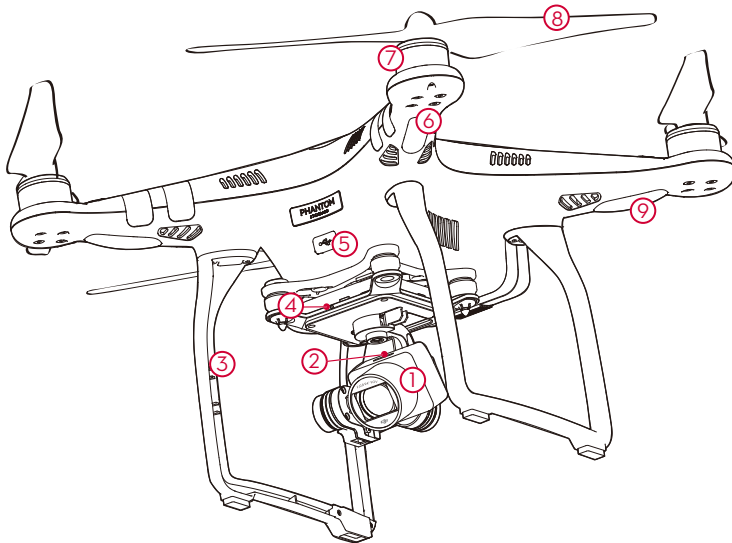

- 1. Gimbal and Camera
- 2. Micro SD Card Slot
- 3. Antennas
- 4. Camera Status Indicator
- 5. Aircraft Micro USB Port
- 6. Front LEDs
- 7. Motors
- 8. Propellers
- 9. Aircraft Status Indicators
- 10. Camera Micro USB Port
- 11. Intelligent Flight Battery
- 12. Power Button
- 13. Battery Level Indicators
- 14. Link Button

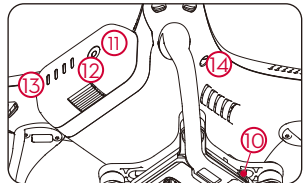

# Remote Controller

The remote controller allows a flying range of 3,280 feet (1000m) in FCC compliant mode and 1,640 feet (500m) in CE compliant mode\*.

Built into the remote controller is a rechargeable lithium battery which lasts for up to three hours. The remote controller supports a Wi-Fi connection which, when paired with a compatible mobile device, enables live HD video transmission through the DJI GO app.

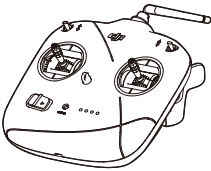
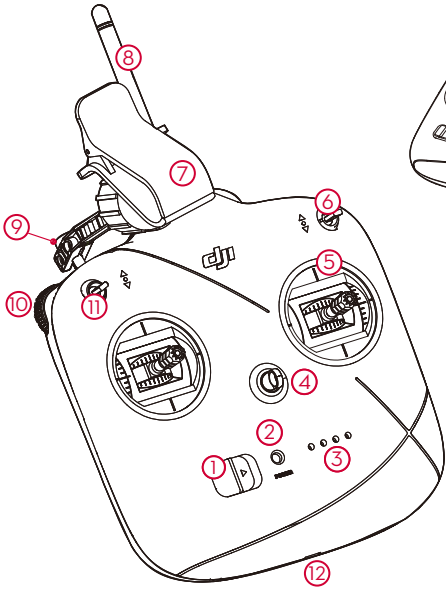

Folded

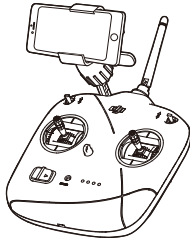

With mobile device mounted

1. Power Switch
2. Status LED
3. Battery Level LEDs
4. Lanyard Loop
5. Control Sticks
6. Switch S1
7. Mobile Device Holder
8. Antenna
9. Handle Bar
10. Gimbal Dial
11. Switch S2
12. Micro USB Port

Here are the default flight controls ( Mode 2 ). The left stick controls the aircraft's altitude and heading, while the right stick controls its forward, backward, left and right movements. The gimbal dial controls the camera's tilt.

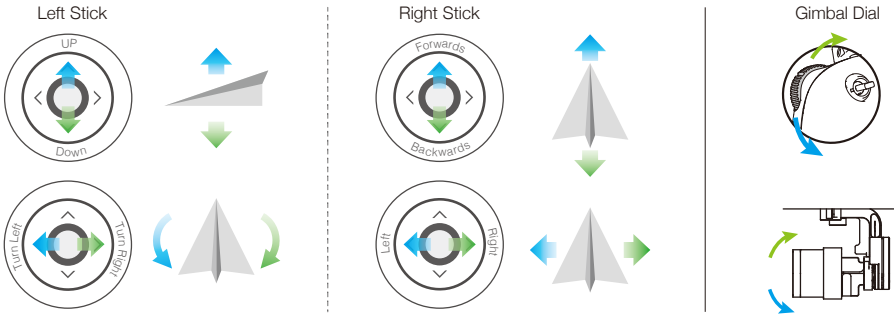

\* In a wide open area with minimal magnetic interference, and at an altitude of about 400 feet (120 meters), the remote controller is able to reach its maximum transmission distance – FCC compliant mode at 3280 feet (1000 meters) and CE compliant mode at 1640 feet (500 meters).

# Using PHANTOM 3 Standard

## 1. Download the DJI GO App

Search 'DJI GO' on the App Store or Google Play and download the app to your mobile device.



DJI GO App

## 2. Watch the Tutorial Videos

Watch the tutorial videos at [www.dji.com](http://www.dji.com) or in the DJI GO app.



Tutorial Videos

 • The DJI GO app supports iOS 8.0 and Android 4.1.2, or later versions.

## 3. Check the Battery Levels

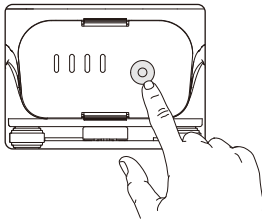

Low ← Battery Level → High



Press once to check the battery level.  
Press twice and hold to turn on/off.

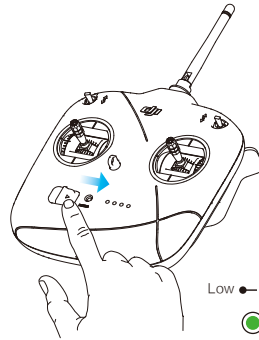

Low ← Battery Level → High



## 4. Charge the Batteries

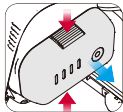

Remove the battery.

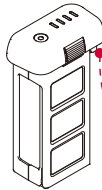

Provided Charger  
Charge Time: ~1.5 hours

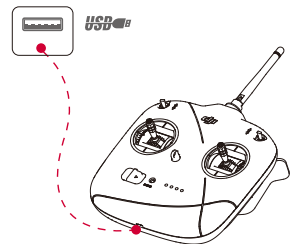
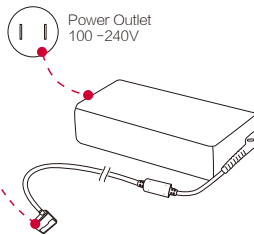

USB Adapter  
Charge Time: ~2.5 hours  
(when charging at 1.5A)

 • When charging is complete, the battery will automatically power off and the Status LED will change from red to green.



## 5. Prepare the Remote Controller

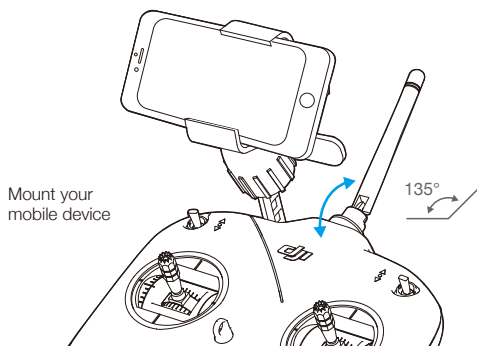
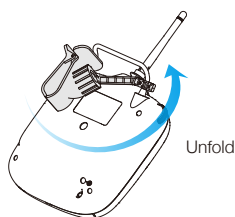

## 6. Prepare for Takeoff

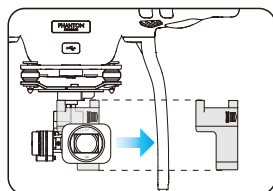

Remove the gimbal clamp on the camera.

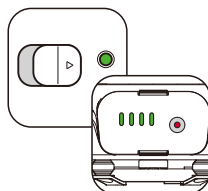

Power on the remote controller and the aircraft.



On your mobile device, select 'PHANTOM3\_XXX' from the Wi-Fi networks and enter the default password '12341234'.



Activate your Phantom if you are using it for the first time. This requires an internet connection.



Launch the app and tap Enter Camera View, then follow the on-screen instructions.

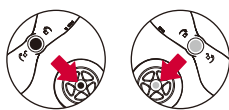

Black propeller nuts go on motors with black dots.  
Silver propeller nuts go on motors without black dots.

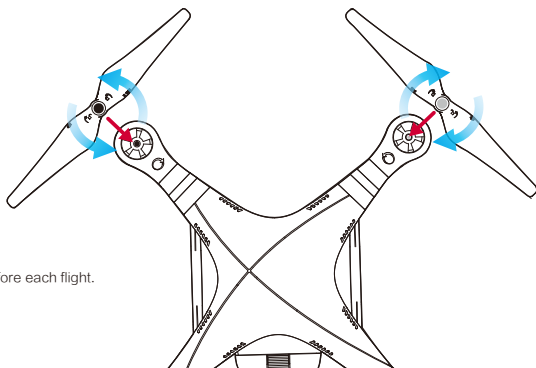

• Tighten the propellers with both hands before each flight.

## 7. Flight

### Safe to Fly (GPS)

Before taking off, ensure the Aircraft Status Bar in the DJI GO app indicates 'Safe to Fly (GPS)'.

In the DJI GO App:



#### Auto Takeoff

The aircraft will take off and hover at an altitude of 4 feet (1.2 meters).



#### Auto Landing

The aircraft will land vertically and stop its motors.



#### Return-To-Home

Brings the aircraft back to the Home Point. Tap again to stop the procedure.



- The aircraft will not avoid obstacles while it is returning to the Home Point, and an appropriate RTH altitude **MUST** be set before flight. You should also use the control sticks to guide the aircraft. Refer to the Safety Guidelines and Disclaimer for more details.

#### Manual Takeoff



OR



Combination Stick Command to start/stop the motors

Left stick up (slowly) to take off

#### Manual Landing



Left stick down (slowly) until you touch the ground  
Hold a few seconds to stop the motors



- Never stop the motors mid-flight, otherwise the aircraft will crash. Only stop the motors when the aircraft is on the ground or as required in emergency situations to reduce the risk of damage or injury.

## 8. Fly Safe

DJI encourages you to enjoy flying in a safe, responsible and smart way.

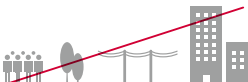

**DO NOT FLY** near or above people, near trees, power lines or buildings.



**DO MONITOR YOUR ALTITUDE** and fly under 400 feet (120 meters).

It is important to understand basic flight guidelines, for the safety of both you and those around you. Refer to the Safety Guidelines and Disclaimer for more information.



**DO NOT FLY** in rain, snow, fog, and wind speeds exceeding 22 mph or 10 m/s.



**DO MAINTAIN LINE OF SIGHT** and avoid flying behind buildings or obstacles that block your view.



No Fly Zones

More information at:  
<http://fllysafe.dji.com/no-fly>

## Specifications

### • Aircraft

Weight (Including Battery)	1216 g
Max. Ascent Speed	5 m/s
Max. Descent Speed	3 m/s
Max. Speed	16 m/s (ATTI mode, no wind)
Max. Flight Altitude	6000 m
Max. Flight Time	Approximately 25 minutes
Operating Temperature Range	0 °C to 40 °C
GPS	Satellite navigation system

### • Gimbal

Controllable Range	Pitch: - 90° to +30°
Angular Vibration Range	±0.02°

### • Camera

Sensor	1/2.3" Effective pixels:12 M
Lens	FOV (Field of View) 94° 20 mm (35 mm format equivalent) f/2.8
ISO Range	100-3200 (video) 100-1600 (photo)
Electronic Shutter Speed	8 s - 1/8000 s
Image Max. Size	4000 x 3000
Still Photography Modes	Single shot Burst shooting: 3/5/7 frames Auto Exposure Bracketing (AEB): 3/5 bracketed frames at 0.7 EV Bias Time-lapse
Video Recording Modes	UHD: 2.7Kp30 (2704 x1520) FHD: 1920x1080p 24/25/30 HD: 1280x720p 24/25/30/48/50/60
Max. Bitrate of Video Storage	40 Mbps
Supported File Formats	FAT32/exFAT Photo: JPEG, DNG Video: MP4/MOV (MPEG-4 AVC/H.264)
Supported SD Card Types	Micro SD, Max. capacity: 64GB. Class 6 or higher
Operating Temperature Range	0 °C to 40 °C

### • Wi-Fi Video Link

Operating Frequency	2.400 GHz - 2.483 GHz
Max. Transmission Distance	FCC: 1000 m; CE: 500 m (outdoors and unobstructed, aircraft's altitude at 400 feet (120 m))
Transmitter Power (EIRP)	FCC: 27 dBm; CE: 20 dBm

### • Remote Controller

Operating Frequency	5.725 GHz - 5.825 GHz, 922.7 MHz - 927.7 MHz (Japan)
Max. Transmission Distance	FCC: 1000 m; CE: 500 m (outdoors and unobstructed, aircraft's altitude at 400 feet (120 m))
Operating Temperature Range	0 °C to 40 °C
Battery	2600 mAh LiPo 18650
Transmitter Power (EIRP)	FCC: 19 dBm; CE: 14 dBm
Working Voltage	600 mA @ 3.7V
Charging Port	Micro USB

### • Charger

Voltage	17.4 V
Rated Power	57 W

### • Intelligent Flight Battery ( PH3-4480 mAh-15.2 V )

Capacity	4480 mAh
Voltage	15.2 V
Battery Type	LiPo 4S
Energy	68 Wh
Net Weight	365 g
Operating Temperature	-10 °C to 40 °C
Max. Charging Power	100 W

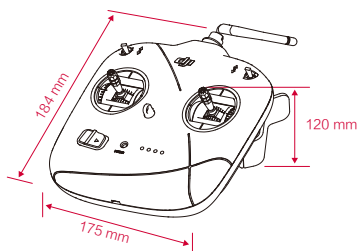
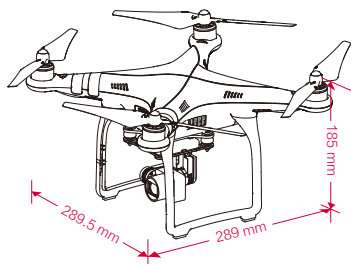

CE 1313

FCC ID: S53-WM321503 FCC ID: S53-GL3581503  
 This device complies with part 15 of the FCC Rules.  
 Operation is subject to the following two conditions:  
 (1) This device may not cause harmful interference, and  
 (2) this device must accept any interference received, including interference that may cause undesired operation.

Download the user manual for more information:

<http://www.dji.com/product/phantom-3-standard>



※ This Quick Start Guide is subject to change without prior notice.

# PHANTOM 3

STANDARD